



WSU26/3-103A00

WSU/WEU26-3

SINGLE-BEAM PHOTOELECTRIC SAFETY SWITCHES

SICK
Sensor Intelligence.



Ordering information

Scanning range	System part	Type	Part no.
70 m	Sender	WSU26/3-103A00	1047984

Other models and accessories → www.sick.com/WSU_WEU26-3



Detailed technical data

Features

Type of light	Infrared light
Scanning range	70 m
Dimension of the light path	0.5 m ... 70 m
Number of beams	1
Detection capability	30 mm
Front screen heating	✓
Synchronization	Optical synchronisation

Safety-related parameters

Type	Type 4 (IEC 61496-1)
Safety integrity level	SIL3 (IEC 61508) SILCL3 (EN 62061)
Category	Category 4 (EN ISO 13849)
Performance level	PL e (EN ISO 13849)
B_{10d} parameter	1 x 10 ⁶ switching cycles (AC-15, 230 V, 0.4 A), 2.6 x 10 ⁵ switching cycles (AC-15, 230 V, 2.0 A), 1 x 10 ⁶ switching cycles (DC-13, 24 V, 0.6 A), 2 x 10 ⁵ switching cycles (DC-13, 24 V, 1.5 A)
PFH_p (mean probability of a dangerous failure per hour)	4.0 x 10 ⁻⁹ (EN ISO 13849)
T_M (mission time)	20 years (EN ISO 13849)
Safe state in the event of a fault	At least one OSSD is in the OFF state.

Interfaces

Connection type	PG gland (13,5)
Display elements	LEDs
Fieldbus, industrial network	
Integration via Flexi Soft safety controller	CANopen ¹⁾ DeviceNet™ EtherCAT®

¹⁾ For additional information on Flexi Soft -> www.sick.com/Flexi_Soft.

	EtherNet/IP™ Modbus TCP PROFIBUS DP PROFINET
--	---

¹⁾ For additional information on Flexi Soft -> www.sick.com/Flexi_Soft.

Electrical data

Protection class	I (EN 50178)
Supply voltage V_S	24 V DC (19.2 V DC ... 28.8 V DC)
Power consumption	≤ 6 W
Switch-on time	≤ 10 s ¹⁾
Test input	Volt-free N/C contact

¹⁾ Upon applying the supply voltage.

Mechanical data

Design	Rectangular
Dimensions (W x H x D)	50 mm x 156 mm x 116 mm
Housing material	Aluminum die cast
Front screen material	Polycarbonate, scratch-resistant coating
Weight	≤ 1 kg

Ambient data

Enclosure rating	IP67 (EN 60529)
Ambient operating temperature	-25 °C ... +55 °C
Storage temperature	-25 °C ... +70 °C
Air humidity	15 % ... 95 %, Non-condensing
Vibration resistance	5 g, 10 Hz ... 55 Hz (IEC 60068-2-6)
Shock resistance	10 g, 16 ms (IEC 60068-2-29)

Other information

Type of light	Infrared light
Wave length	950 nm

Classifications

ECl@ss 5.0	27272701
ECl@ss 5.1.4	27272701
ECl@ss 6.0	27272701
ECl@ss 6.2	27272701
ECl@ss 7.0	27272701
ECl@ss 8.0	27272701
ECl@ss 8.1	27272701
ECl@ss 9.0	27272701
ECl@ss 10.0	27272701
ECl@ss 11.0	27272701
ETIM 5.0	EC001831
ETIM 6.0	EC001831

WSU26/3-103A00 | WSU/WEU26-3

SINGLE-BEAM PHOTOELECTRIC SAFETY SWITCHES



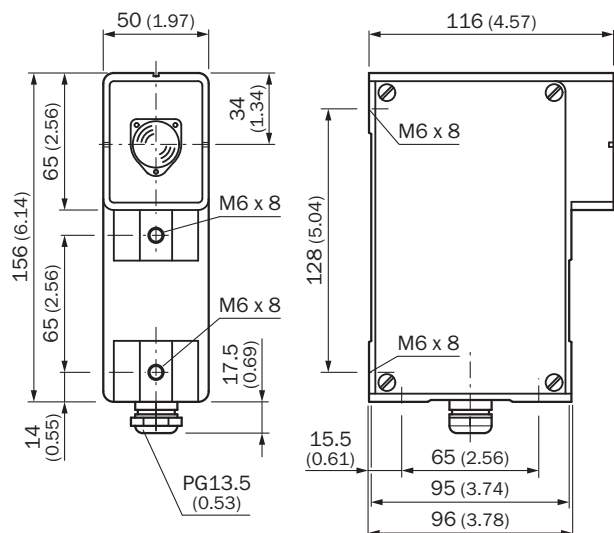

ETIM 7.0	EC001831
UNSPSC 16.0901	46171620





Dimensional drawing (Dimensions in mm (inch))

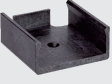

Recommended accessories

Other models and accessories → www.sick.com/WSU_WEU26-3

	Brief description	Type	Part no.
Mounting brackets and plates			
	Bracket, face side mounting position	BEF-4WNAEFAL1	2007900
	Spring mounting for PSK1 deflector mirror	BEF-4AAAAHST3	2012473
Terminal and alignment brackets			
	Bracket for PSK1 deflector mirror	BEF-4GHAAHAL1	2009292
Alignment aids			
	Laser alignment aid for various sensors, laser class 2 (IEC 60825). Do not look into the beam!	AR60	1015741
	Adapter AR60 for WSU/WEU26-3 and WSU/WEU26/2	AR60 adapter, WSU/WEU26	4031156

	Brief description	Type	Part no.
Deflector mirrors			
	Horizontal deflection, 75 mm x 80 mm reflector surface, Glass, Incl. mounting kit (2 x swivel mount)	PNS75-008	1026647
	Horizontal deflection, 96 mm x 124 mm reflector surface, Glass	PSK1	1005229
	Deflector mirror for 90° deflection, mirror surface 97 mm x 80 mm, not suitable for column mounting, Glass, mounting hardware included	PSK45	5306053
Test and monitoring tools			
	30 mm diameter	Test rod 30 mm	2022602
Adapters and distributors			
	Two-way splitter	Two-way splitter	5305978
	PG extension for PG13 to PG21	PG extension for PG13 to PG21	5306052

SICK AT A GLANCE

SICK is one of the leading manufacturers of intelligent sensors and sensor solutions for industrial applications. A unique range of products and services creates the perfect basis for controlling processes securely and efficiently, protecting individuals from accidents and preventing damage to the environment.

We have extensive experience in a wide range of industries and understand their processes and requirements. With intelligent sensors, we can deliver exactly what our customers need. In application centers in Europe, Asia and North America, system solutions are tested and optimized in accordance with customer specifications. All this makes us a reliable supplier and development partner.

Comprehensive services complete our offering: SICK LifeTime Services provide support throughout the machine life cycle and ensure safety and productivity.

For us, that is “Sensor Intelligence.”

WORLDWIDE PRESENCE:

Contacts and other locations –www.sick.com