

AOD5-P1

SICK
Sensor Intelligence.



Ordering information

Type	Part no.
AOD5-P1	6035985

Other models and accessories → www.sick.com/

Detailed technical data

Technical specifications

Accessory family	Evaluation units
Additional function	Arithmetic calculations, Mean-value setting 1 ... 4,096x, selectable measuring frequency (automatic / 0.1 ms ... 3.2 ms), Frequency filters
Connection type head A	Terminal board
Communication interface	Serial, RS-232 USB
Switching output	5 x PNP, 100 mA ^{1) 2)}
Analog output	3 x 4 mA ... 20 mA ($\leq 300 \Omega$) 3 x -10 V ... 10 V (output resistance 100 Ω , min. load 10 k Ω)
Housing material	Polycarbonat and nylon 66
Operating voltage	DC 12 V (-5 %) ... DC 24 V (+10 %)
Power consumption	$\leq 10.8 \text{ W}^3)$
Ambient operating temperature	-10 °C ... +45 °C
Enclosure rating	IP20
Weight	550 g
Description	Evaluation unit: OD Precision, 5 x PNP

¹⁾ PNP: HIGH = $V_S - (< 2 \text{ V})$ / LOW = $< 2 \text{ V}$; NPN: HIGH = $< 2 \text{ V}$ / LOW = V_S .

²⁾ With use of 50-pin I/O extension terminal (accessory).

³⁾ When connected with three sensor heads, incl. analog current output.

Classifications

ECl@ss 5.0	27270890
ECl@ss 5.1.4	27270890
ECl@ss 6.0	27270890
ECl@ss 6.2	27270890
ECl@ss 7.0	27270890
ECl@ss 8.0	27270890
ECl@ss 8.1	27270890
ECl@ss 9.0	27270892
ECl@ss 10.0	27270892
ECl@ss 11.0	27270892
ECl@ss 12.0	27270992
ETIM 5.0	EC001825
ETIM 6.0	EC001825

ETIM 7.0	EC001825
ETIM 8.0	EC001825
UNSPSC 16.0901	41111613

Dimensional drawing (Dimensions in mm (inch))

AOD5-xx

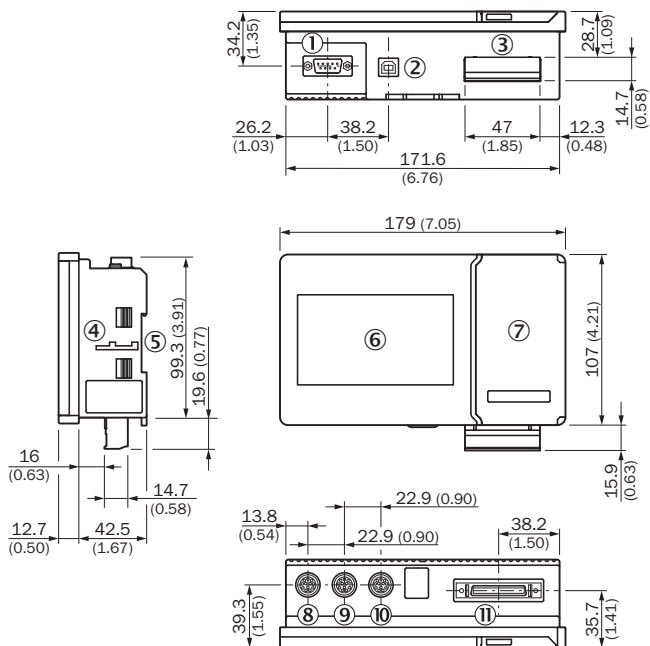

- ① RS-232C interface
- ② USB interface
- ③ Terminal board (detachable)
- ④ For panel mounting bracket (recommended window size 173 mm x 102 mm)
- ⑤ DIN rail mounting
- ⑥ LC display
- ⑦ Control elements
- ⑧ Sensor head A connection port
- ⑨ Sensor head B connection port
- ⑩ Sensor head C connection port
- ⑪ External input and output terminal, 50-pin (see IO-EXP-AOD5 accessories)

Connection type

Connection diagram RS-232C

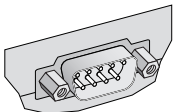

Terminal block connection type

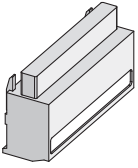

Anschlusschema

Connection diagram RS-232C

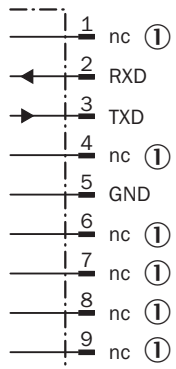

① Not assigned

Terminal block connection diagram

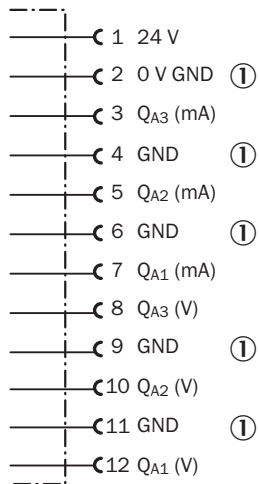

① Ground (0 V)

Adjustments

AOD5-xx

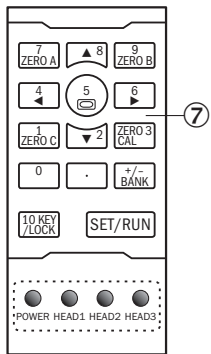

⑦ Control elements

SICK AT A GLANCE

SICK is one of the leading manufacturers of intelligent sensors and sensor solutions for industrial applications. A unique range of products and services creates the perfect basis for controlling processes securely and efficiently, protecting individuals from accidents and preventing damage to the environment.

We have extensive experience in a wide range of industries and understand their processes and requirements. With intelligent sensors, we can deliver exactly what our customers need. In application centers in Europe, Asia and North America, system solutions are tested and optimized in accordance with customer specifications. All this makes us a reliable supplier and development partner.

Comprehensive services complete our offering: SICK LifeTime Services provide support throughout the machine life cycle and ensure safety and productivity.

For us, that is “Sensor Intelligence.”

WORLDWIDE PRESENCE:

Contacts and other locations –www.sick.com